

Assembling and Disassembling of Pump Elements

- Pump elements should be assembled with the primary grease piston partially exposed approximately 30mm (Fig 3).
- Inserted pump element now into the pump housing orifice in an upward inclination (Fig 3).
- When the piston touches the thrust ring, the pump element should now be moved to the horizontal position (to Fig 4).
- Make sure that piston head will be located in the groove of the guide ring.
- Tighten pump element not more than 25-30 Nm.
- Reversing this sequence for pump element disassembling.
- When removing a pump element, ensure that the piston (1) does not remain in the pump body.

Fig 1

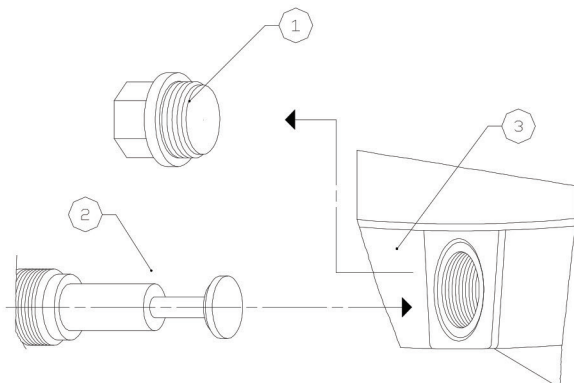

Fig 2

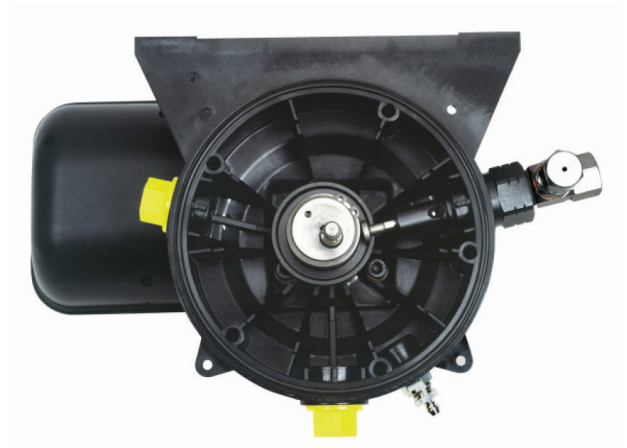

Fig 3

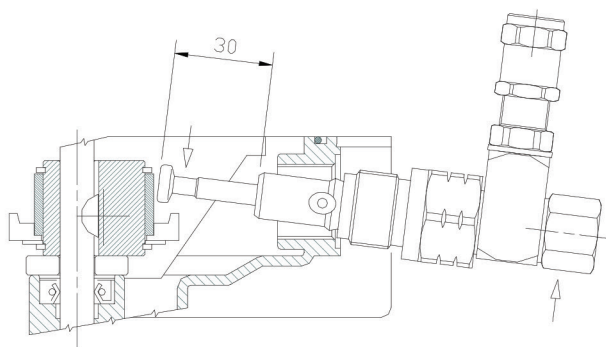

Fig 4

