

Standard flat spray nozzles ST

Spray angle: 110°/80°

Material: POM, ceramic, brass (on request)

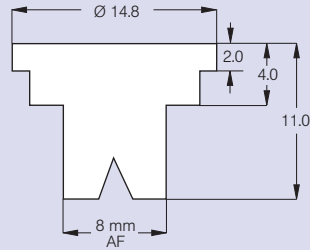

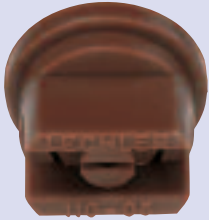

Features

- Flat spray nozzle
- Nozzle sizes 01 through 08
- Pressure range 2.0 to 5.0 bar
- Fits all bayonet cap systems with 8 mm AF
- Colour coded acc. to ISO standard 10625

Range of application

- Application of plant protectants and growth regulators

|  (80 M) |  [bar] | l/min | l/ha | | | | | | | | |
|---|--|-------|----------|----------|----------|----------|-----------|-----------|-----------|-----------|-----------|
| | | | 5.0 km/h | 6.0 km/h | 7.0 km/h | 8.0 km/h | 10.0 km/h | 12.0 km/h | 14.0 km/h | 16.0 km/h | 18.0 km/h |
| ST 110-01 80-01 (80 M) | 2.0 | 0.32 | 77 | 64 | 55 | 48 | 38 | 32 | 27 | 24 | 21 |
| | 2.5 | 0.36 | 86 | 72 | 62 | 54 | 43 | 36 | 31 | 27 | 24 |
| | 3.0 | 0.39 | 94 | 78 | 67 | 59 | 47 | 39 | 33 | 29 | 26 |
| | 3.5 | 0.42 | 101 | 84 | 72 | 63 | 50 | 42 | 36 | 32 | 28 |
| | 4.0 | 0.45 | 108 | 90 | 77 | 68 | 54 | 45 | 39 | 34 | 30 |
| ST 110-015 80-015 (80 M) | 5.0 | 0.51 | 122 | 102 | 87 | 77 | 61 | 51 | 44 | 38 | 34 |
| | 2.0 | 0.48 | 115 | 96 | 82 | 72 | 58 | 48 | 41 | 36 | 32 |
| | 2.5 | 0.54 | 130 | 108 | 93 | 81 | 65 | 54 | 46 | 41 | 36 |
| | 3.0 | 0.59 | 142 | 118 | 101 | 89 | 71 | 59 | 51 | 44 | 39 |
| | 3.5 | 0.63 | 151 | 126 | 108 | 95 | 76 | 63 | 54 | 47 | 42 |
| ST 110-02 80-02 (60 M) | 4.0 | 0.68 | 163 | 136 | 117 | 102 | 82 | 68 | 58 | 51 | 45 |
| | 5.0 | 0.76 | 182 | 152 | 130 | 114 | 91 | 76 | 65 | 57 | 51 |
| | 2.0 | 0.65 | 156 | 130 | 111 | 98 | 78 | 65 | 56 | 49 | 43 |
| | 2.5 | 0.73 | 175 | 146 | 125 | 110 | 88 | 73 | 63 | 55 | 49 |
| | 3.0 | 0.80 | 192 | 160 | 137 | 120 | 96 | 80 | 69 | 60 | 53 |
| ST 110-03 80-03 (60 M) | 3.5 | 0.86 | 206 | 172 | 147 | 129 | 103 | 86 | 74 | 65 | 57 |
| | 4.0 | 0.92 | 221 | 184 | 158 | 138 | 110 | 92 | 79 | 69 | 61 |
| | 5.0 | 1.03 | 247 | 206 | 177 | 155 | 124 | 103 | 88 | 77 | 69 |
| | 2.0 | 0.97 | 233 | 194 | 166 | 146 | 116 | 97 | 83 | 73 | 65 |
| | 2.5 | 1.08 | 259 | 216 | 185 | 162 | 130 | 108 | 93 | 81 | 72 |
| ST 110-04 80-04 (60 M) | 3.0 | 1.19 | 286 | 238 | 204 | 179 | 143 | 119 | 102 | 89 | 79 |
| | 3.5 | 1.28 | 307 | 256 | 219 | 192 | 154 | 128 | 110 | 96 | 85 |
| | 4.0 | 1.37 | 329 | 274 | 235 | 206 | 164 | 137 | 117 | 103 | 91 |
| | 5.0 | 1.53 | 367 | 306 | 262 | 230 | 184 | 153 | 131 | 115 | 102 |
| | 2.0 | 1.29 | 310 | 258 | 221 | 194 | 155 | 129 | 111 | 97 | 86 |
| ST 110-05 80-05 (25 M) | 2.5 | 1.44 | 346 | 288 | 247 | 216 | 173 | 144 | 123 | 108 | 96 |
| | 3.0 | 1.58 | 379 | 316 | 271 | 237 | 190 | 158 | 135 | 119 | 105 |
| | 3.5 | 1.71 | 410 | 342 | 293 | 257 | 205 | 171 | 147 | 128 | 114 |
| | 4.0 | 1.82 | 437 | 364 | 312 | 273 | 218 | 182 | 156 | 137 | 121 |
| | 5.0 | 2.04 | 490 | 408 | 350 | 306 | 245 | 204 | 175 | 153 | 136 |
| ST 110-06 80-06 (25 M) | 2.0 | 1.61 | 386 | 322 | 276 | 242 | 193 | 161 | 138 | 121 | 107 |
| | 2.5 | 1.80 | 432 | 360 | 309 | 270 | 216 | 180 | 154 | 135 | 120 |
| | 3.0 | 1.97 | 473 | 394 | 338 | 296 | 236 | 197 | 169 | 148 | 131 |
| | 3.5 | 2.13 | 511 | 426 | 365 | 320 | 256 | 213 | 183 | 160 | 142 |
| | 4.0 | 2.28 | 547 | 456 | 391 | 342 | 274 | 228 | 195 | 171 | 152 |
| ST 110-08 80-08 (25 M) | 5.0 | 2.55 | 612 | 510 | 437 | 383 | 306 | 255 | 219 | 191 | 170 |
| | 2.0 | 1.93 | 463 | 386 | 331 | 290 | 232 | 193 | 165 | 145 | 129 |
| | 2.5 | 2.16 | 518 | 432 | 370 | 324 | 259 | 216 | 185 | 162 | 144 |
| | 3.0 | 2.36 | 566 | 472 | 405 | 354 | 283 | 236 | 202 | 177 | 157 |
| | 3.5 | 2.55 | 612 | 510 | 437 | 383 | 306 | 255 | 219 | 191 | 170 |
| ST 110-08 80-08 (25 M) | 4.0 | 2.73 | 655 | 546 | 468 | 410 | 328 | 273 | 234 | 205 | 182 |
| | 5.0 | 3.05 | 732 | 610 | 523 | 458 | 366 | 305 | 261 | 229 | 203 |
| | 2.0 | 2.58 | 619 | 516 | 442 | 387 | 310 | 258 | 221 | 194 | 172 |
| | 2.5 | 2.88 | 691 | 576 | 494 | 432 | 346 | 288 | 247 | 216 | 192 |
| | 3.0 | 3.16 | 758 | 632 | 542 | 474 | 379 | 316 | 271 | 237 | 211 |
| ST 110-08 80-08 (25 M) | 3.5 | 3.41 | 818 | 682 | 585 | 512 | 409 | 341 | 292 | 256 | 227 |
| | 4.0 | 3.65 | 876 | 730 | 626 | 548 | 438 | 365 | 313 | 274 | 243 |
| | 5.0 | 4.08 | 979 | 816 | 699 | 612 | 490 | 408 | 350 | 306 | 272 |

- Spray pressure at the nozzle tip (gauged with a diaphragm valve).
- The stated liter-per-hectare rates apply to water.
- Prior to each spraying season, verify the table data by gauging the flow rates.
- Make sure that all nozzles have the same settings.

Sample order

Type + spray angle + int'l nozzle size + material = order number
 ST 110° 06 (POM) = ST 110-06
 ST 110° 06 C (ceramic) = ST 110-06 C