

## Off-center flat spray nozzles OC (large sizes)

Spray angle: 90°  
Material: brass

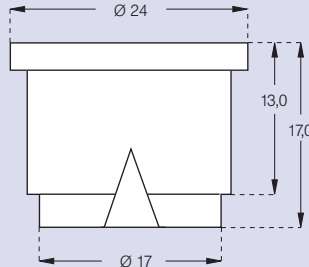

### Features

- Off-center flat spray nozzle
- Nozzle sizes 40 to 80
- Pressure range 2.0 to 5.0 bar
- Fits 3/4" threaded caps with Ø 20 mm
- Spraying range 6 to 8 m
- Asymmetrical spray pattern via eccentric orifice

### Range of application

- Boom irrigation
- Moistening of indoor riding arenas
- Watering cars

### Mounting/adjusting of boom-sprayer nozzles

Mount one wide-angle nozzle at each end of the boom. The individual nozzles are supplied with liquid via additional part-width connections to feed branches of

existing, adequately sized feedlines. Take care to ensure that the implement has a sufficiently powerful pump, because a pair of wide-angle nozzles consume (80 l/min.)

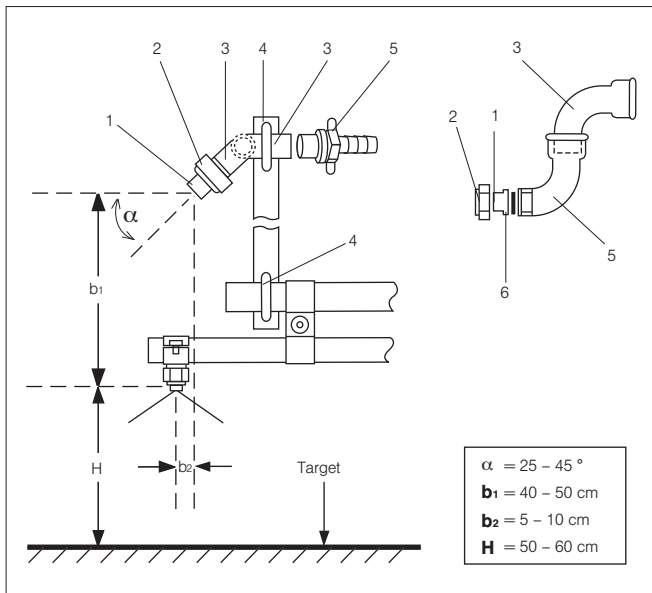

	l/min				Recommended combination with flat-spray tips, e.g. LU-/IDK-/IDKN-nozzles
	[bar]				
	2.0	3.0	4.0	5.0	
<b>OC 40-846</b>	12.50	15.30	17.70	19.80	-03/-04
<b>OC 60-926</b>	20.00	24.49	28.28	31.62	-05/-06
<b>OC 80-966</b>	25.00	30.62	35.36	39.53	-06/-08

- Application data valid for water
- Gauge the nozzle flow rates prior to each spraying season
- Spray pressure at the nozzle tip (gauged with a diaphragm valve)

### Spraying range/effective working width

The spraying range is a function of the setting angle  $\alpha$ :

Setting angle $\alpha$ (degree)	Spraying range a (m) circa
25	9.0
30	8.5
35	8.0
40	6.0
45	5.5



Item	Description	Order no.
1	OC nozzle	OC 40-846 OC 60-926 OC 80-966
2	Threaded cap	065.600.30.00
3	90° elbow 3/4" male and female threads	-
4	Pipe clamp	-
5	3/4" hose shank	095.016.53.05.60
6	Gasket	065.640.72.00