

Anti-drift nozzles AD



G 1666
G 1667
G 1668



AD



AD-C

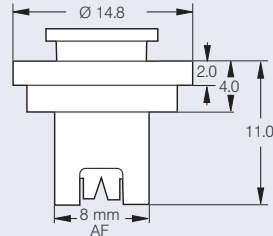

Spray angle: 120°/90°
Material: POM, ceramic

Features

- One-piece nozzle, with removable insert and integrated pre-chamber
- Nozzle size 015 to 04
- Pressure range AD 120: 1.5 to 6.0 bar (arable crops)
AD 90: 2.0 to 20.0 bar (space crops)
- Fits all bayonet cap systems with 8 mm AF
- Medium-to-coarse, low-drift application, even for low l/ha rates

Range of application

- Application of plant protectants and growth regulators



Cleaning brush for AD nozzles
Order no. 06A.D30.56.00

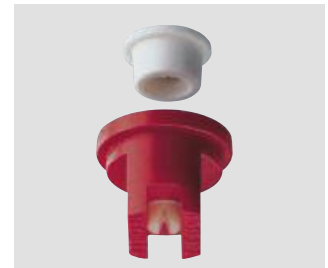

Integrated pre-chamber for optimal drop-size characteristics

The special design of the pre-chamber inflow section, reduces the undesirable fine-droplets fraction. Within the pre-chamber itself, the pressure is dissipated before the liquid emerges. This effectively minimizes the tip's susceptibility to wear.

BCPC/ASAE Droplet size classification

VF	Very fine
F	Fine
M	Medium
C	Coarse
VC	Very coarse
EC	Extreme Coarse

Classifications are subject to change

Nozzle Type	BCPC/ASAE	Pressure [bar]	Flow l/min	l/ha								
				5.0 km/h	6.0 km/h	7.0 km/h	8.0 km/h	10.0 km/h	12.0 km/h	14.0 km/h	16.0 km/h	18.0 km/h
AD 120-015 (80 M)	M	1.5	0.42	101	84	72	63	50	42	36	32	28
	M	2.0	0.48	115	96	82	72	58	48	41	36	32
	M	2.5	0.54	130	108	93	81	65	54	45	41	36
	M	3.0	0.59	142	118	101	89	71	59	51	44	39
	F	3.5	0.63	151	126	108	95	76	63	54	47	42
	F	4.0	0.68	163	136	117	102	82	68	58	51	45
	F	4.5	0.72	173	144	123	108	86	72	62	54	48
	F	5.0	0.76	182	152	130	114	91	76	65	57	51
AD 120-02 90-02 (60 M)	C	1.5	0.56	134	112	96	84	67	56	47	42	37
	M	2.0	0.65	156	130	111	98	78	65	54	49	43
	M	2.5	0.73	175	146	125	110	88	73	61	55	49
	M	3.0	0.80	192	160	137	120	96	80	67	60	53
	M	3.5	0.86	206	172	147	129	103	86	73	65	57
	M	4.0	0.92	221	184	158	138	110	92	77	69	61
	F	4.5	0.98	235	196	168	147	118	98	82	74	65
	F	5.0	1.03	247	206	177	155	124	103	87	77	69
AD 120-03 90-03 (60 M)	C	1.5	0.84	202	168	144	126	101	84	70	63	56
	C	2.0	0.97	233	194	166	146	116	97	81	73	65
	C	2.5	1.08	259	216	185	162	130	108	91	81	72
	M	3.0	1.19	286	238	204	179	143	119	100	89	79
	M	3.5	1.28	307	256	219	192	154	128	108	96	85
	M	4.0	1.37	329	274	235	206	164	137	116	103	91
	M	4.5	1.46	350	292	250	219	175	146	123	110	97
	M	5.0	1.53	367	306	262	230	184	153	130	115	102
AD 120-04 90-04 (60 M)	F	6.0	1.68	403	336	288	252	202	168	141	126	112
	C	1.5	1.12	269	224	192	168	134	112	93	84	75
	C	2.0	1.29	310	258	221	194	155	129	108	97	86
	C	2.5	1.44	346	288	247	216	173	144	122	108	96
	C	3.0	1.58	379	316	271	237	190	158	133	119	105
	C	3.5	1.71	410	342	293	257	205	171	144	128	114
	M	4.0	1.82	437	364	312	273	218	182	154	137	121
	M	4.5	1.94	466	388	333	291	233	194	164	146	129
	M	5.0	2.04	490	408	350	306	245	204	173	153	136
	M	6.0	2.23	535	446	382	335	268	223	189	167	149

Sample order

Type + spray angle + int'l nozzle size + material = order number
 AD 120° 02 (POM) = AD 120-02
 AD 120° 02 C (ceramic) = AD 120-02 C

