

Hose drop system 5S and 5SL

Flexible hose drop system with weight loaded 5-orifice tip for late liquid fertilizer application.

Advantages

- No scorching, because weight-loaded 5-orifice tip is submerged in crop
- 5-orifice tip distributes the liquid fertilizer uniformly in the crop with 0.5 m hose spacing
- In comparison with 0.25 m hose drop system, lower boom loading when pulling through the crop
- Compliance with transport width by ideal adaption of the hose when boom is folded
- Extension as spacer with hose attachment prevents paint damage to the sprayer when folded in
- Including bayonet cap system MULTIJET (incl. gasket) as standard
- Selection of l/ha rate by nozzle plates

 **Tube spacing**
0.25 and 0.5 m
(depending on boom)

 **Dosing orifice**
- 5S:
1.0 and 1.2 mm
- 5SL:
1.5 and 1.8 mm

 **Spray angle**
160°

 **Pressure range**
1 – 5 bar

Application area

 Liquid fertilizer
- 5S:
50 - 300 l/ha UAN
- 5SL:
180 - 550 l/ha UAN

NEW

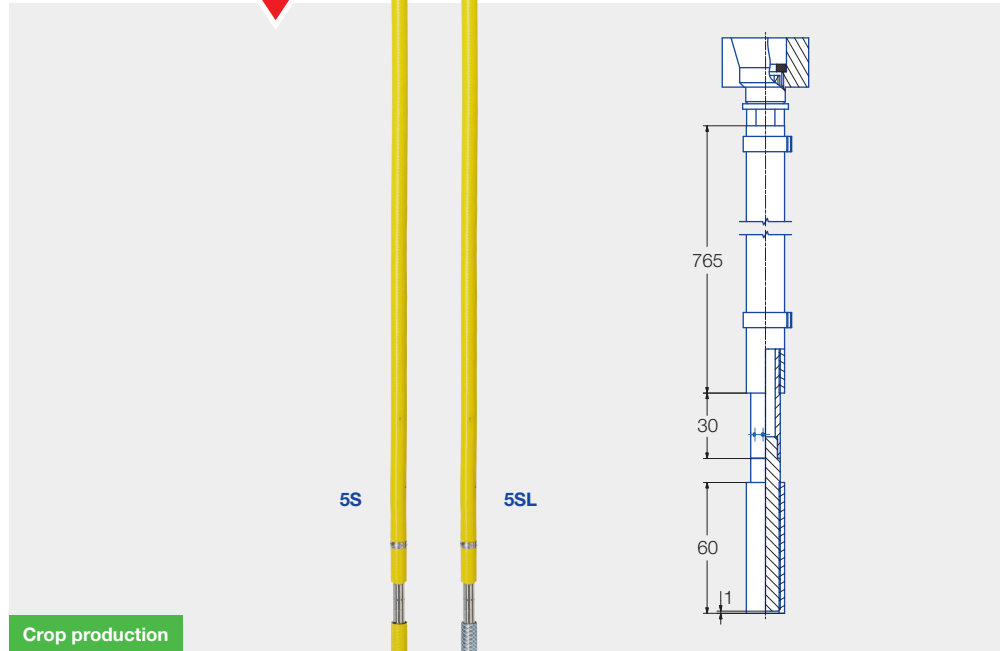

Assembly instruction

Inscription on dosing orifice must face upwards when inserted in the bayonet cap!



Assembly instruction

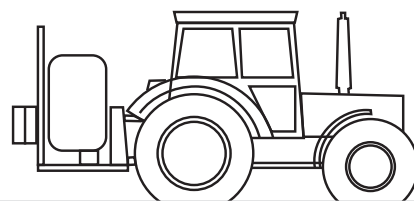

Fit hose drop system 5S and 5SL facing forwards in driving direction when assembling on the field spray boom. When the system floats up slightly, the nozzle will then spray directly into the crop.



Direction of travel = spraying direction



Spray table for hose drop system 5S and 5SL

 ø mm		l/min	UAN l/ha at 0.5 m nozzle spacing					UAN l/ha at 0.75 m nozzle spacing					
			Water	UAN	5 km/h	6 km/h	7 km/h	8 km/h	10 km/h	5 km/h	6 km/h	7 km/h	8 km/h
1,0/39 5S	1	0.46	0.41	98	81	70	61	49	65	54	46	41	33
	2	0.65	0.57	138	115	98	86	69	92	77	66	57	46
	3	0.80	0.71	170	141	121	106	85	113	95	81	71	57
	4	0.92	0.81	195	163	139	122	98	130	108	93	81	65
	5	1.03	0.91	218	182	156	137	109	146	121	104	91	73
1,2/48 5S	1	0.67	0.59	142	118	102	89	71	95	79	68	59	47
	2	0.95	0.84	202	168	144	126	101	134	112	96	84	67
	3	1.16	1.03	246	205	176	154	123	164	137	118	103	82
	4	1.34	1.18	284	237	203	178	142	190	158	135	118	95
	5	1.50	1.33	318	265	227	199	159	212	177	152	133	106
1,5/59 5SL	1	0.98	0.87	208	173	148	130	104	139	115	99	87	69
	2	1.38	1.22	293	244	209	183	146	195	163	139	122	98
	3	1.69	1.49	359	299	256	224	179	239	199	171	149	120
	4	1.95	1.72	414	345	295	259	207	276	230	197	172	138
	5	2.18	1.93	462	385	330	289	231	308	257	220	193	154
1,8/72 5SL	1	1.39	1.23	295	246	211	184	147	197	164	140	123	98
	2	1.96	1.73	416	346	297	260	208	277	231	198	173	139
	3	2.40	2.12	509	424	364	318	255	339	283	242	212	170
	4	2.77	2.45	588	490	420	367	294	392	326	280	245	196
	5	3.10	2.74	658	548	470	411	329	438	365	313	274	219

Description	Order. no.
Hose drop system 5S	092.173.00
Dosing orifices	
1.0 mm/39 stainless steel	050.030.1C.01.00
1.2 mm/48 stainless steel	050.030.1C.03.00
Relocation kit nozzle holder	092.174.00.00.00.0

Description	Order. no.
Hose drop system 5SL	092.173.00.01.00
Dosing orifices	
1.5 mm/59 stainless steel	050.030.1C.02.00
1.8 mm/72 stainless steel	050.030.1C.04.00

- Prior to each spraying season verify the table data by gauging the flow rates
- Make sure that in all hoses the same dosing orifice are fitted
- Lateral hose spacing 0.5 m
- Spray pressure at dosing orifice (gauged with a diaphragm valve)
- The stated liter-per-hectare rates apply to UAN (28/1.29 kg/l)

NEU

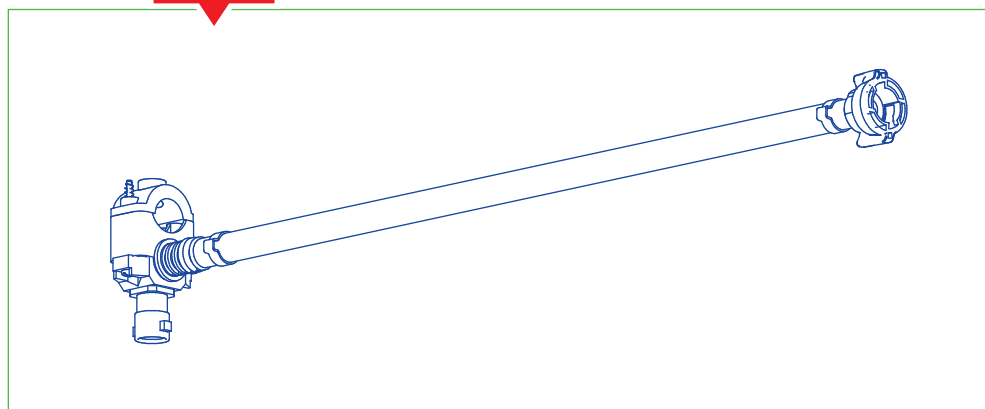

Row width adaption (e.g. corn 0.75 m row spacing) with relocation kit nozzle holder
 3/4" (25 - 28 cm) on request
 assembly to wet boom 1/2" (20 - 22 cm)

Find further information
 in our manual:

www.lechler-agri.com/manuals

