

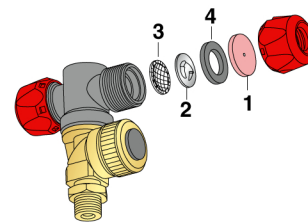

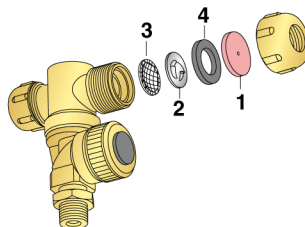



Ordinare piastrina, convogliatore, filtro e guarnizione in base alle esigenze, per ogni uscita del getto vuoto ordinato.

Commander plaqueette, convoyeur, filtre et joint selon les exigences, pour chaque sortie de la buse vide commandée.

Platte, Drallkörper, Filter und Dichtung sind in Abhängigkeit der Ansprüche für jeden Ausgang der in Auftrag gegebenen leeren Düse zu bestellen.



| 1  Ø18mm Ø getto Ø plaqueette Ø Platte | COD. | 2  Ø convogliatore Ø convoyeur Ø Drallkörper | COD. | bar | | | | | | | | 3  | 4  | | |
|---|------------------|--|------------------|--|------|------|------|------|------|-------|-------|---|---|------------------|------------------|
| | | | | 5 | 10 | 15 | 20 | 25 | 30 | 35 | 40 | | | 45 | 50 |
| | | | |  l/1' | | | | | | | | | | | |
| | | | | | | | | | | | | COD. | COD. | | |
| 0.8 | 00HP18008 | - | 00HP18200 | 0.70 | 0.98 | 1.08 | 1.26 | 1.42 | 1.54 | 1.66 | 1.76 | 1.84 | 1.92 | 00HP18300 | 00HP18100 |
| 1 | 00HP18010 | - | 00HP18200 | 0.65 | 1.02 | 1.18 | 1.40 | 1.58 | 1.76 | 1.74 | 2.04 | 2.16 | 2.68 | | |
| | | 1 | 00HP18210 | 1.02 | 1.38 | 1.72 | 1.96 | 2.22 | 2.56 | 2.64 | 2.84 | 3.08 | 3.21 | | |
| | | - | 00HP18200 | 0.78 | 1.32 | 1.53 | 1.86 | 2.04 | 2.19 | 2.37 | 2.55 | 2.76 | 2.88 | | |
| 1.2 | 00HP18012 | 1 | 00HP18210 | 1.20 | 1.62 | 2.16 | 2.61 | 3.03 | 3.30 | 3.54 | 3.84 | 3.93 | 4.20 | | |
| | | 1.2 | 00HP18212 | 1.50 | 2.00 | 2.48 | 2.88 | 3.64 | 3.88 | 4.12 | 4.48 | 4.72 | 4.96 | | |
| | | - | 00HP18200 | 1.02 | 1.65 | 1.92 | 2.40 | 2.56 | 2.88 | 2.92 | 3.06 | 3.10 | 3.35 | | |
| 1.5 | 00HP18015 | 1 | 00HP18210 | 1.89 | 3.39 | 3.99 | 4.83 | 5.48 | 5.96 | 6.32 | 6.52 | 6.67 | 6.85 | | |
| | | 1.2 | 00HP18212 | 2.19 | 3.30 | 4.08 | 4.60 | 5.22 | 5.88 | 6.48 | 6.90 | 7.20 | 7.82 | | |
| | | 1.5 | 00HP18215 | 2.37 | 3.48 | 4.32 | 5.16 | 5.88 | 6.30 | 7.08 | 7.56 | 8.16 | 8.88 | | |
| | | - | 00HP18200 | 1.56 | 2.36 | 3.04 | 3.36 | 3.84 | 4.32 | 4.74 | 5.04 | 5.28 | 5.64 | | |
| 1.8 | 00HP18018 | 1 | 00HP18210 | 2.36 | 3.96 | 5.12 | 6.06 | 7.02 | 7.80 | 8.28 | 9.00 | 9.30 | 10.20 | | |
| | | 1.2 | 00HP18212 | 2.76 | 4.26 | 5.52 | 6.12 | 7.06 | 7.92 | 8.40 | 9.12 | 10.32 | 11.04 | | |
| | | 1.5 | 00HP18215 | 2.71 | 3.93 | 5.20 | 6.21 | 7.62 | 8.52 | 9.24 | 10.44 | 11.76 | 12.72 | | |
| | | 1.8 | 00HP18218 | 3.00 | 4.68 | 5.88 | 6.96 | 8.16 | 8.76 | 10.08 | 10.92 | 12.24 | 12.96 | | |
| | | - | 00HP18200 | 1.40 | 2.28 | 2.94 | 3.42 | 3.78 | 4.20 | 4.32 | 4.92 | 5.16 | 6.12 | | |
| 2 | 00HP18020 | 1 | 00HP18210 | 2.72 | 3.60 | 4.32 | 5.58 | 5.82 | 6.72 | 8.16 | 8.88 | 9.96 | 10.44 | | |
| | | 1.2 | 00HP18212 | 3.00 | 4.20 | 5.52 | 6.96 | 7.20 | 8.16 | 9.60 | 10.44 | 11.52 | 12.49 | | |
| | | 1.5 | 00HP18215 | 3.35 | 4.65 | 5.76 | 6.90 | 7.80 | 8.76 | 10.20 | 11.04 | 11.97 | 13.08 | | |
| | | 1.8 | 00HP18218 | 3.97 | 5.16 | 6.18 | 7.38 | 8.16 | 9.36 | 10.92 | 12.49 | 12.96 | 14.28 | | |