

# DONGHUA Worksnorm roller chains

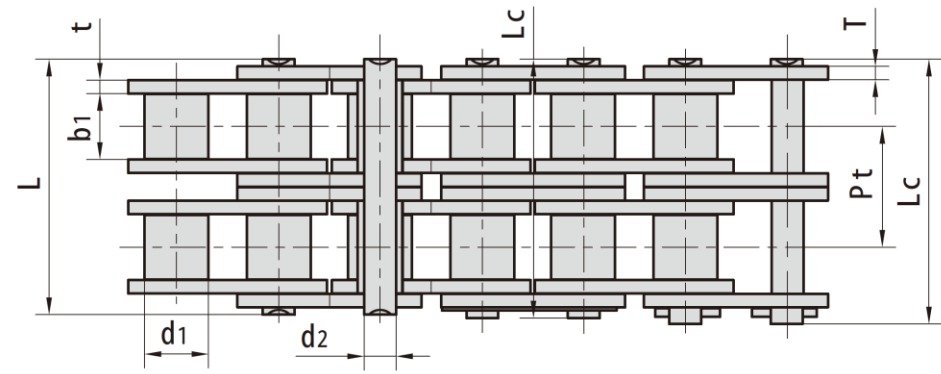

Donghua chain type	Pitch	Roller diameter	Inner width	Pin diameter	Pin length		Plate height	Plate thickness	Transver pitch	Avarage tensile strength	Weigth per meter	Connecting parts
ISO/DIN chain nr.	P	d1 max.	b1 min.	d2 max.	L max.	Lc max.	h2 max.	t/T max.	Pt	Q	q	
	mm	mm	mm	mm	mm	mm	mm	mm	mm	kN	kg/m	
<b>Worksnorm Series</b>												
205	12,7	8,51	6,4	4,45	15,2	16,3	11,8	1,6/1,3	-	19,0	0,85	A/E/L
317	15,875	10,16	6,45	5,08	16,4	18,2	14,7	1,70	-	24,2	0,89	A/E/L
425	19,05	12,07	13,5	5,72	28,8	30,3	16,5	2,80	-	37,5	1,72	A/E/L
480	19,05	12,07	11,68	6,10	25,0	27,2	16,5	2,50	-	45,5	1,46	A/E/L
514	25,4	14,00	12,7	7,00	28,5	30,5	19,7	3,00	-	49,5	1,88	A/E/L
516	25,4	15,88	12,7	8,28	30,8	32,1	21,0	3,5/3,0	-	63,0	2,37	A/E/L
525	25,4	12,7	12,7	7,00	28,5	30,5	20,8	3,00	-	49,5	1,59	A/E/L
626	30	15,88	17,02	8,28	35,6	38,7	20,0	3,5/3,0	-	66,0	2,58	A/E/L

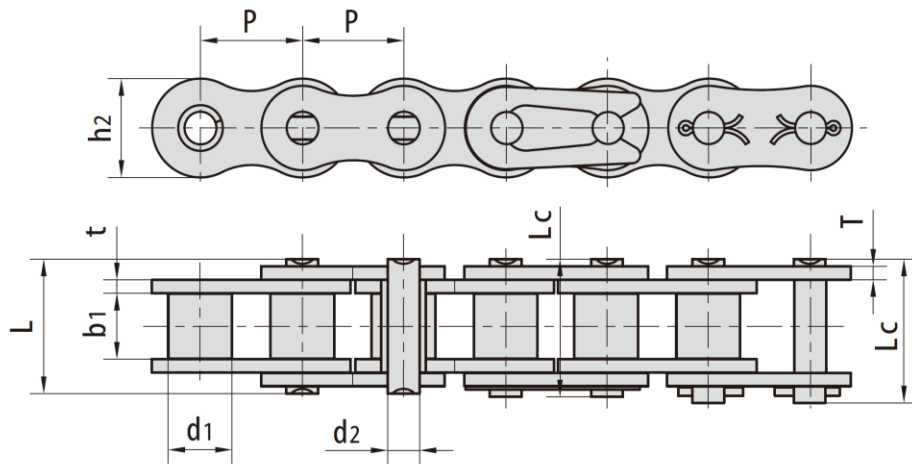

**A**  
Outer link  
Press fit



**E**  
Spring connecting link  
Loose fit



**L**  
One pitch  
Offset link



**S**  
Cotter connecting link  
Loose fit