

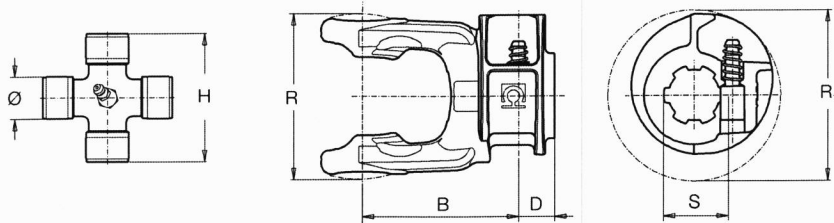

Gabeln für einfaches Kardangelenk

Gabeln mit Schiebepin



	Ø	H	S	D	B	R	R ₁	Best.-Nr.	Ersatzteil	
	mm	mm		mm	mm	mm	mm	Gabel	Nr.	
1	22.0	54.0	1 3/8" Z6	18	75	67	85	007	5070B0355	403000021R10
			1 3/8" Z21	26	67	67	85	008	5070B3755	403000021R10
			D8x32x38	18	75	67	85	093	5070B2151	403000021R10
2	23.8	61.3	1 3/8" Z6	21	78	76	85	007	5070C0355	403000021R10
			1 3/8" Z21	29	70	76	85	008	5070C3755	403000021R10
			D8x32x38	21	78	76	85	093	5070C2151	403000021R10
43-4	27.0	74.6	1 3/8" Z6	21	85	89	100	007	5070E0355	403000001R10
			1 3/8" Z21	29	77	89	100	008	5070E3755	403000001R10
			D8x32x38	21	85	89	100	093	5070E2151	403000001R10
5	30.2	79.4	1 3/8" Z6	21	91	98	100	007	5070G0355	403000001R10
			1 3/8" Z21	29	83	98	100	008	5070G3755	403000001R10
			D8x32x38	21	91	98	100	093	5070G2151	403000001R10
			1 3/4" Z6	--	--	--	--	--	--	--
6	30.2	91.4	1 3/8" Z6	24	95	108	100	007	5070H0355	403000001R10
			1 3/8" Z21	32	87	108	100	008	5070H3755	403000001R10
			D8x32x38	24	95	108	100	093	5070H2151	403000001R10
			1 3/4" Z6	--	--	--	--	--	--	--
7	35.0	93.5	1 3/8" Z6	24	98	113	108	007	5070L0355	403000032R10
			1 3/8" Z21	32	90	113	108	008	5070L3755	403000032R10
			D8x32x38	24	98	113	108	093	5070L2151	403000032R10
			1 3/4" Z6	--	--	--	--	--	--	--
8	35.0	106.0	1 3/8" Z6	24	103	124	107	007	5070M0355	403000032R10
			1 3/8" Z21	32	95	124	107	008	5070M3755	403000032R10
			D8x32x38	24	103	124	107	093	5070M2151	403000032R10
			1 3/4" Z6	--	--	--	--	--	--	--
			1 3/4" Z20	--	--	--	--	--	--	